



Elmstone Drive, Royton

£339,950

🛏 4 🚿 2 🛋 3



- Executive Detached Family Home
- Master En Suite
- Well Fitted Kitchen
- Private Rear Garden
- Four/Five Bedrooms
- Two/Three Reception Rooms
- Driveway Parking
- EPC rating C



Located within easy reach of Royton town centre is this lovely four/Five bedroom detached family home offered in lovely condition throughout. Accommodation comprising: Entrance hallway, lounge, dining room, sitting room/bedroom five, cloakroom/WC and a good size kitchen. To the first floor there are four bedrooms, one En-suite shower room and a family bathroom. Externally there is a well appointed rear garden with side access and parking to the front. Royton and local amenities within easy reach as is motorway networks. Call us today to arrange a viewing on this superb property.

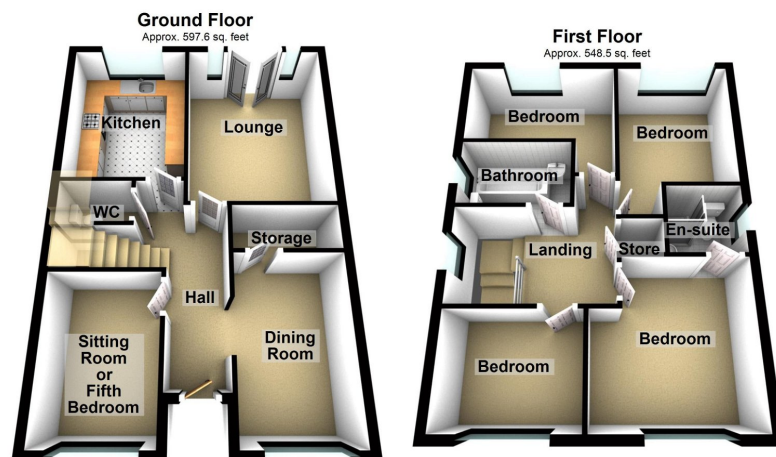

Total area: approx. 1146.0 sq. feet

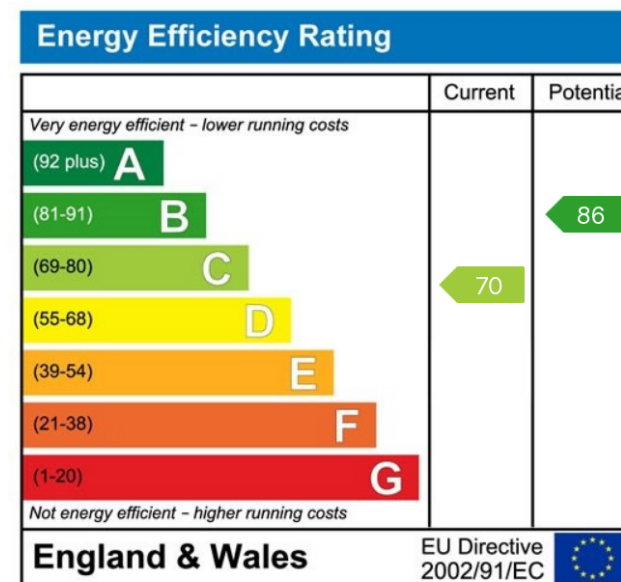

Chadderton Office

509 Middleton Road,
Chadderton, Oldham,
OL9 9SH

chadderton@kirkham-property.co.uk
t: 0161 626 5688